

Upper Floor Plan

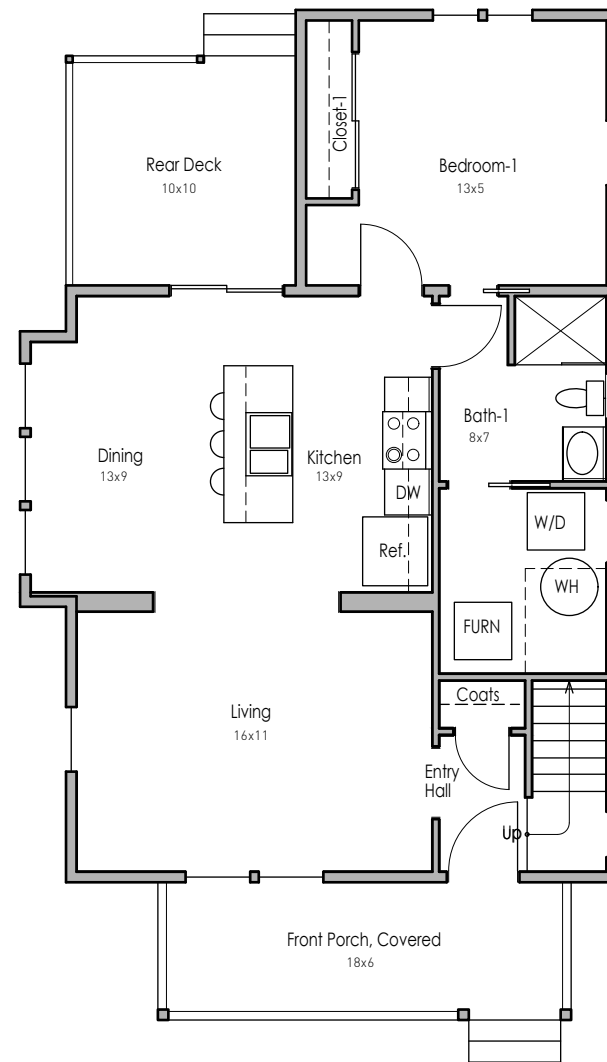

Main Floor Plan



Front Elevation

# American FourSquare

Type - B Design

Date: 7 - 29 - 2019 Designs are subject to changes and updates

One-and-a Half Story  
 Three Bedrooms (Master on Main Floor)  
 Two Bath  
 Covered Front Porch  
 Rear Deck  
 1,416 SF (792 SF Main Floor, 624 SF Upper Floor)

B-Town Cohousing S. Maxwell St. Bloomington, IN

Developer & Builder: Loren Wood Builders

Designer: Marc Cornett, Architect